

Installation manual



■ Outlet

MD-O-CM-O, A, V, T

MD-O-OH-O, A, V, T

MD-O-PB-O, A, V, T

This instruction manual contains **IMPORTANT WARNINGS, CAUTIONS and INSTRUCTIONS**.
Read and understand this instruction manual before use and retain for reference.

Introduction

Important information - Safety precautions

Be sure to read and understand this instruction manual. The operator shall be fully conversant with the requirements stated within this instruction manual including important warnings, cautions and operation. Improper use may result in death / serious injury or cause damage to equipment, property or patients.

All information in this manual is only for ANEST IWATA Outlets.

ANEST IWATA Outlets will be handled in accordance with this manual when operated.

The Outlets must be checked periodically. If there are some parts that are broken, missing, worn, distorted or contaminated, please contact ANEST IWATA or their distributors.

ANEST IWATA Outlets should not be repaired or altered. All warranty on the Outlets will be void upon any such actions attempted by the customers.





Keep this manual in an appropriate place for immediate reference.

◆ Safety guidelines

- Safety guidelines in this manual describe the minimum necessary information. Be sure to follow national and local regulations on fire prevention, electricity and safety as well as your own corporate regulations.
- Items indicated WARNING or CAUTION are very important for your safety.
- To help recognize this information, observe the following symbols.

Signs for WARNINGS and CAUTIONS

 WARNING	Indicates a potentially hazardous situation which, if not avoided, may result in serious injury or loss of life.
 CAUTION	Indicates a potentially hazardous situation which, if not avoided, may result in minor or moderate injury or property damage.



WARNING



Maintenance

Risk of gas leaking

Be sure to conduct maintenance. If not, it may cause leaking of medical gas or stopping of the gas service to patients



CAUTION



Plugging

Risk of plug popping out, gas service suspension.

Make sure that the adapter plug of the secondary equipment is connected securely to the Medical Gas Outlet (there should be a clicking sound).
It may cause the adapter plug to pop out and / or the gas service to be suspended



Damaged

Risk of plug popping out, gas service suspension.

In case any damage or defect is found in any part of the connected equipment, do not use it.

It may cause the adapter plug to pop out and / or the gas service to be suspended



Over tighten

Risk of distortion.

Make sure to not over tighten the mounting screws. When installing the "Latch valve assembly".
It may cause distortion of the latch valve assembly.



Damaged

Risk of plug popping out, gas service suspension.

In case any damage or defect is found in any part of the connected equipment, do not use it.

It may cause the adapter plug to pop out and / or the gas service to be suspended

Table of Contents

Introduction.....	2
Important information - Safety precautions	2
1. Description	3
1-1. General Description	3
1-2. Storage	3
2. Before use	4
2-1. Check the product	4
2-2. Names of components	4
3. Installation	5
3-1. Rough-in assembly	5
3-2. Latch valve assembly and Trim plate.....	6
4. Inspection and Testing	6
4-1. Test for leakage and fitting of adapter plug.....	6
5. Operation.....	7
5-1. Name of components (example: Oxygen of each type).....	7
5-2. Connect with adapter plug of the secondary equipment.....	7
5-3. Remove adapter plug of secondary equipment from outlet.....	7
6. Maintenance.....	8
6-1. Daily maintenance	8
6-2. Periodic maintenance.....	8
6-3. Maintenance parts (Example: Oxygen type).....	8
7. Specifications.....	10
8. Disposal	10
9. Warranty	10

1. Description

1-1. General description

ANEST IWATA Outlets

- Comply with NFPA 99 (2012)
- Certified with ISO22196 “SIAA antibacterial coating” on the surface of the outlet.
- Composed of three items: Rough-in assembly, Latch valve assembly, and Trim plate
(Refer to 2-2).

1-2. Storage

Please Keep ANEST IWATA Outlets in stock under the following conditions.

- Under normal temperature inside the room.
- Well-ventilated (avoid exposure to high humidity)
- No any surrounding toxic gases (solvent vapor, corrosive gas, etc...).
- Do not put heavy items on the carton box of ANEST IWATA Outlets.

2. Before use

2-1. Check the product

- ✓ Check the Rating name plate label (Refer to 2-2) of the products to ensure that it is exactly what you have ordered. Please do not use for different gas types.
- ✓ How to read the model number

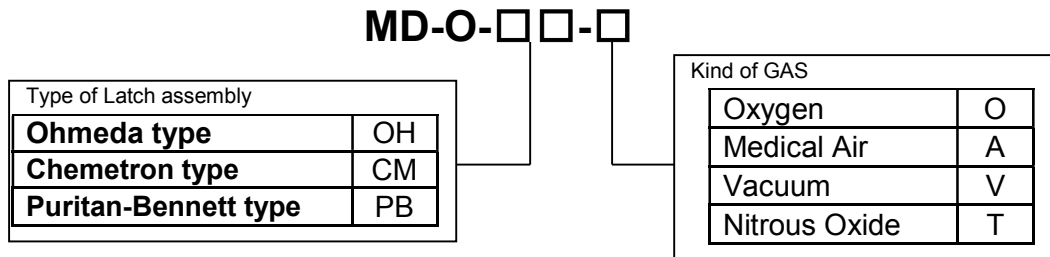

- ✓ **Check for any shipping damage**

Inspect carefully for any damage that may have occurred during transportation. If there was any damage, please contact ANEST IWATA or their distributors.

- ✓ **Check the components**

ANEST IWATA Outlets consists of 3 blocks: Latch assembly, Trim plate and Rough-in assembly.

(Refer to 2-2)

2-2. Names of components

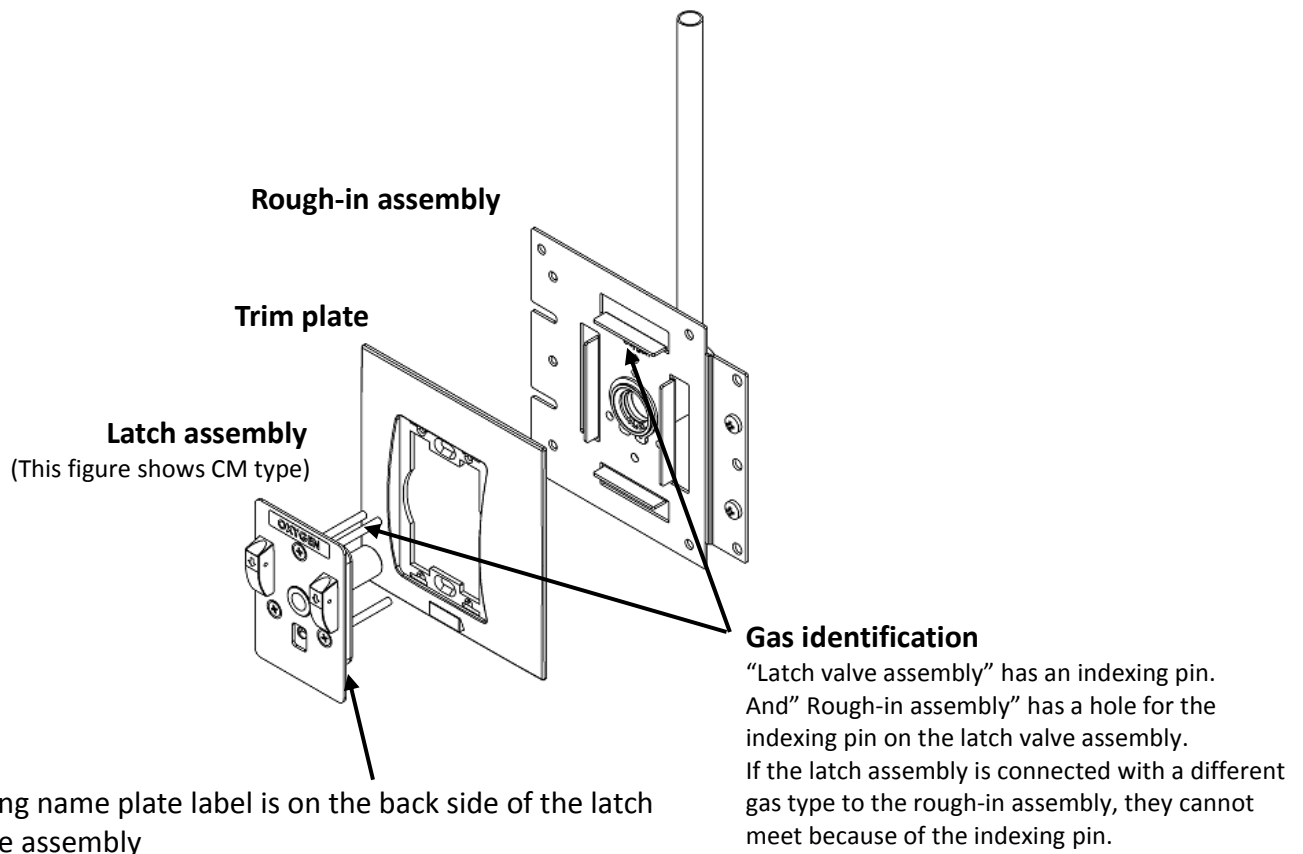

3. Installation

3-1. Rough-in assembly

Rough-in assembly must be installed in the wall before the construction of the wall is finished. Rough-in assemblies are connectable to each other side by side. Make sure the alignment pins of a Rough-in assembly fit the alignment holes of the adjacent one, then fasten the joint screws (provided).

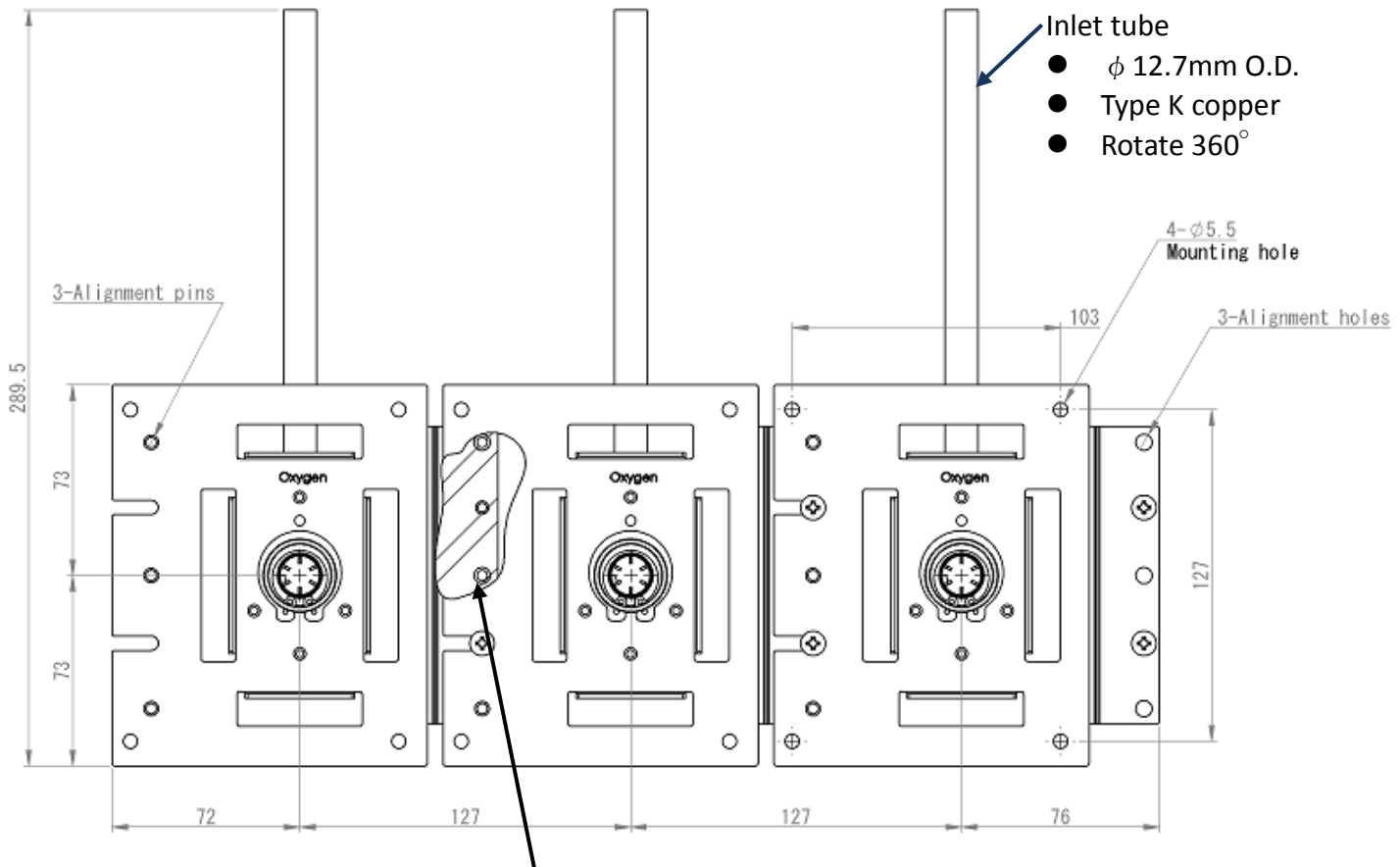

Unit: mm

The alignment pin fits into the alignment hole of the next Rough-in assembly.



3-2. Latch valve assembly and Trim plate

Install the Latch valve and Trim plate with Rough-In assembly after construction of the wall is finished.

- Adoptable thickness of wall panel: 12-25mm
- Minimum size of wall panel cut-out : (W) 55mm × (H) 95mm

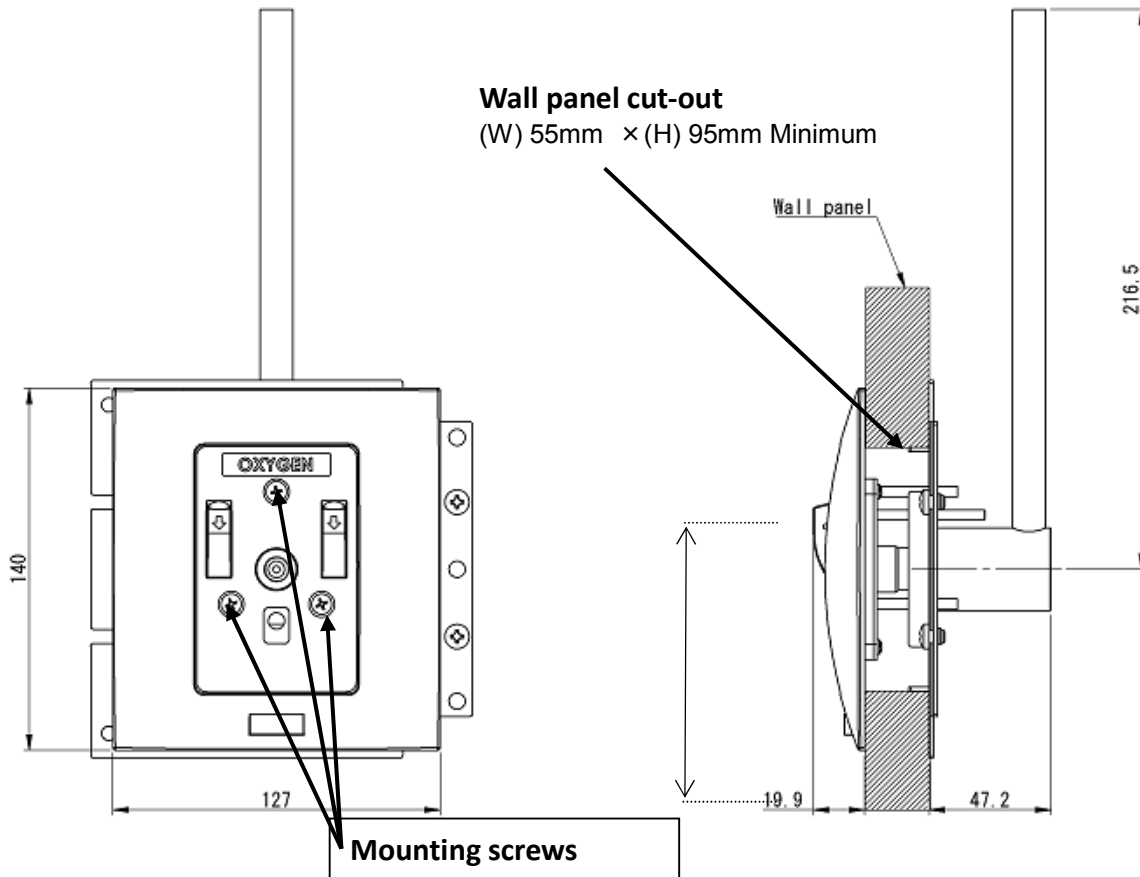
Dimension (Example: CM type)



 CAUTION	
<p>Risk of distortion. Make sure not to over tighten the mounting screws when installing the "Latch valve assembly". It may cause distortion of the Latch valve assembly.</p>	 Over tighten

4. Inspection and Testing

ANEST IWATA Outlets should be inspected periodically. The test should comply with NFPA99 "Gas and Vacuum systems".

4-1. Test for leakage and fitting of adapter plug.

1. Please check for leakage without the adapter plug of the secondary equipment.
2. Insert the adapter plug of the secondary equipment into the "Latch valve assembly".
3. Please check that the adapter plug of the secondary equipment is inserted smoothly into the "Latch valve assembly" and securely latched.
4. Please check again for leakage.



5. Operation

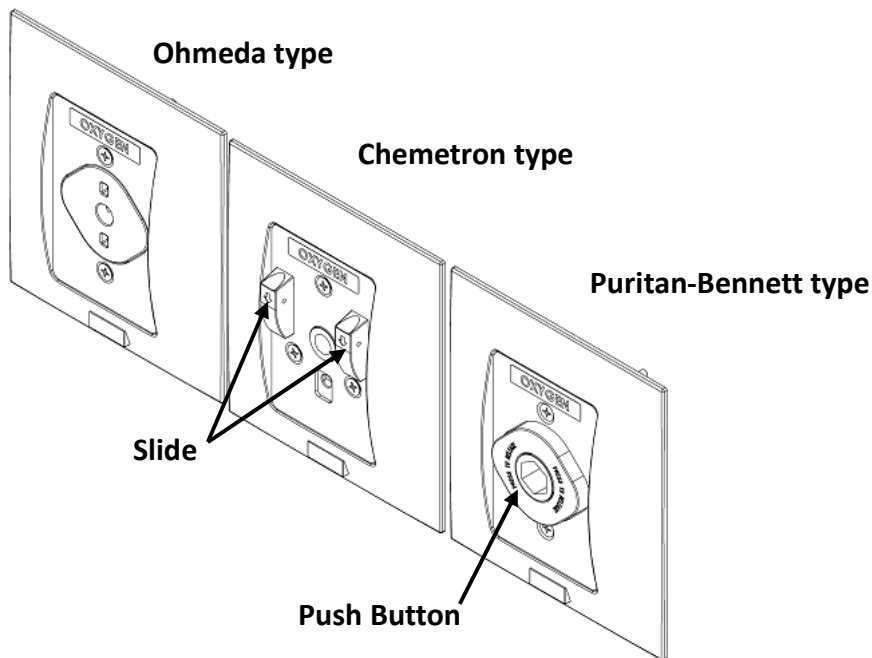

5-1. Name of components (example: Oxygen of each type)



5-2. Connect with adapter plug of the secondary equipment

Insert the adapter plug of the secondary equipment into the Medical Gas outlet.

 CAUTION	
<p>Risk of plug popping out, gas service suspension. Make sure that the adapter plug of the secondary equipment is connected securely to the Medical Gas Outlet (there should be a clicking sound). It may cause the adapter plug to pop out and / or the gas service to be suspended</p>	 Unplugging

 CAUTION	
<p>Risk of plug popping out, gas service suspension. In case any damage or defect is found in any part of the connected equipment, do not use it. It may cause the adapter plug to pop out and / or the gas service to be suspended</p>	 Damaged

5-3. Remove adapter plug of secondary equipment from outlet

Ohmeda type

Turn the plug of the secondary equipment.
(Refer to the manual of the secondary equipment.)

Chemetron type

Pull down both sides of the "SLIDE" with your fingers. (Refer to 5-1)

Puritan-Bennett type

Push the "Push Button" against the wall. (Refer to 5-1)

6. Maintenance

WARNING

Risk of gas leaking

Be sure to conduct maintenance. If not, it may cause leaking of medical gas or stopping of the gas service to patients



Maintenance

6-1. Daily maintenance

- ◆ Please keep the Outlets and adapter plugs of the secondary equipment clean.
- ◆ Check the following every time you use the equipment.

Item	Points	Actions
Latch assembly	Latch doesn't work properly	Replace the Latch assembly before the replacement period.

6-2. Periodic maintenance

 Refer to attached "Inspection and Maintenance table".

6-3. Maintenance parts

Ohmeda type

No	Code Nr.	Name	Q'ty
①	9MD-O-OH-L-(Gas *1)	Ohmeda latch valve (Gas *1)	1
②	9MD-O-TP	Trim plate	1
③	9MDOCM-2523	O-Ring	1
④	9MDOPB-1525	O-Ring	1
⑤	9MORI-0534	O-Ring(1)	2
⑥	9MORI-0535	O-Ring(2)	1

Gas *1: Please fill the kind of gas you need

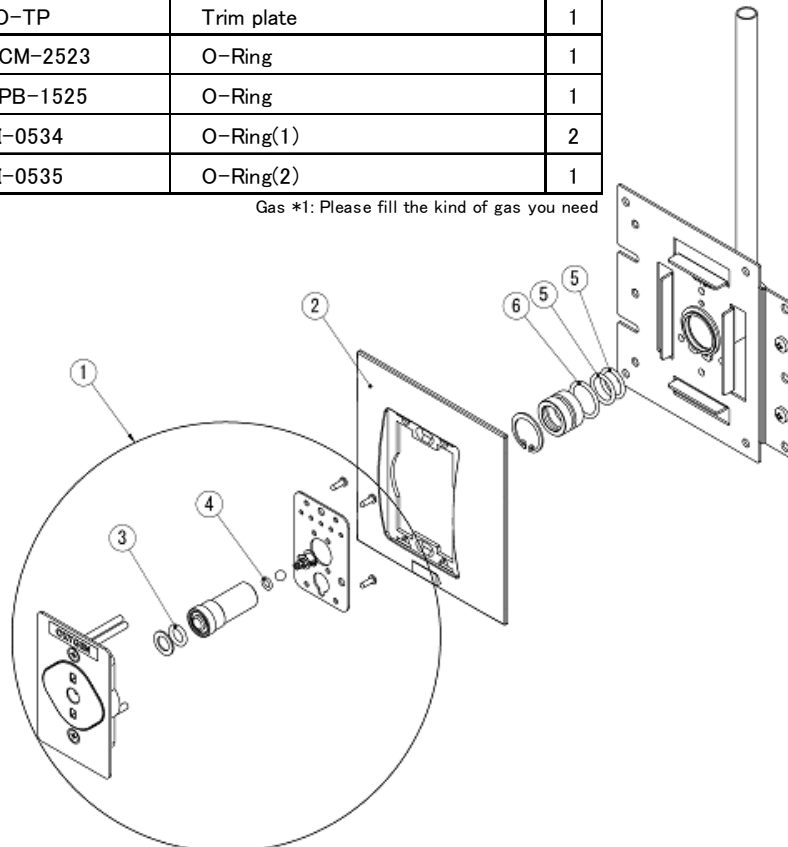

Chemetron type

No	Code Nr.	Name	Q'ty
①	9MD-O-CM-L-(Gas *1)	Chemetron latch valve (Gas *1)	1
②	9MD-O-TP	Trim plate	1
③	9MDOCM-2523	O-Ring	1
④	9MDOPB-1525	O-Ring	1
⑤	9MORI-0534	O-Ring(1)	2
⑥	9MORI-0535	O-Ring(2)	1

Gas *1: Please fill the kind of gas you need

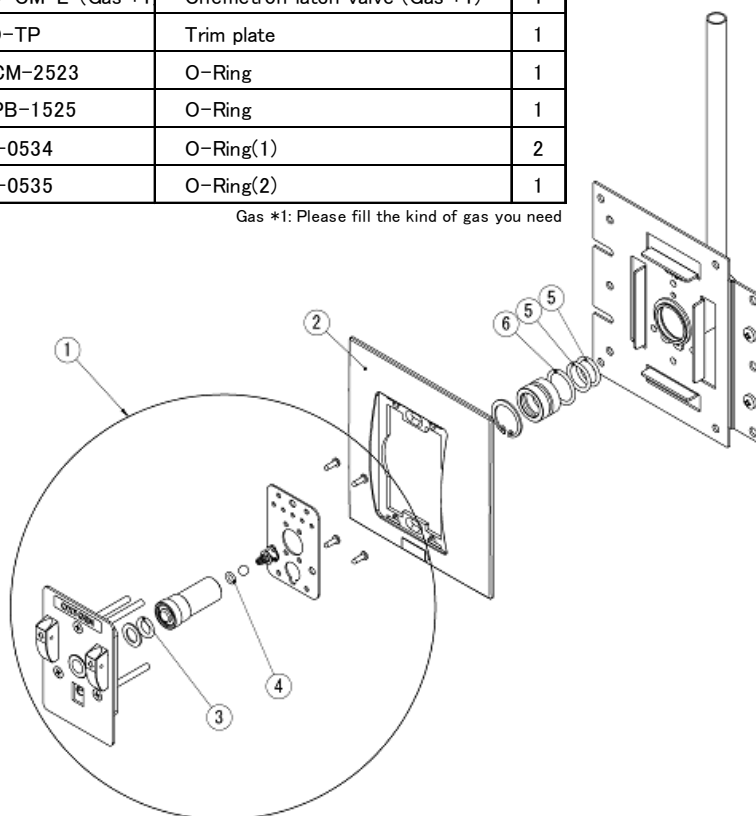

Puritan-Bennett type

No	Code Nr.	Name	Q'ty
①	9MD-O-PB-L-(Gas *1)	Puritan-Bennett latch valve(Gas *1)	1
②	9MD-O-TP	Trim plate	1
③	9MDOPB-1521	Valve sheet	1
④	9MDOPB-1525	O-Ring	1
⑤	9MORI-0534	O-Ring(1)	2
⑥	9MORI-0535	O-Ring(2)	1

Gas *1: Please fill the kind of gas you need

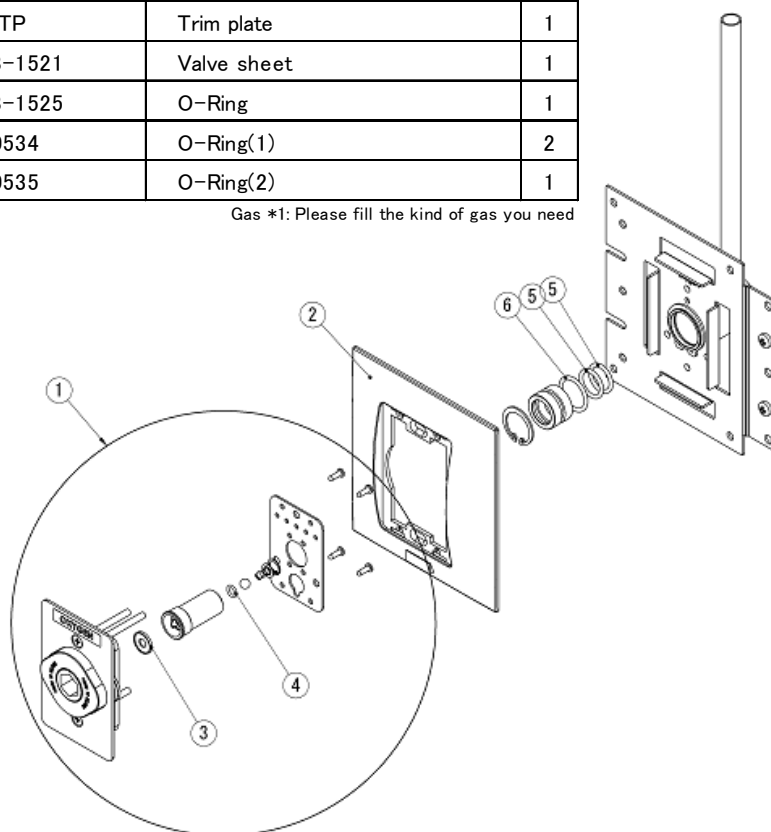

7. Specifications

Model	MD-O-CM-O, A, V, T -OH-O, A, V, T -PB-O, A, V, T	
Proof pressure	kPa	700
Max flow	L/min	300 (345kPa 23°C)
Lubrication	—	Lubricant not used
Weight	kg	0.8
Adoptable panel thickness	mm	12-25

8. Disposal

Please comply with local laws.

9. Warranty



Please refer to the attached sheet.



ANEST IWATA SOUTHEAST ASIA CO., Ltd.

91/1, 5Ath Floor. Chaiyo Building, Room 5A10
Rama 9 Road Huaykwang, Huaykwang, Bangkok 10320, Thailand
TEL +66-(0)-2643-2870 FAX +66-(0)-2643-2874
<http://www.anest-iwatasoutheastasia.com>



Anest Iwata Motherson Pvt. Ltd.

B123-124, Sector 63, Noida 201301, Uttar Pradesh, India
TEL +91-(0)120-4600500 / 14 / 17 FAX+91-(0)120-4600509
<http://www.aimcompressors.com/>

Instruction Manual No. T825-00
Code No. MDOPB-0097